

## Seats and Related Components

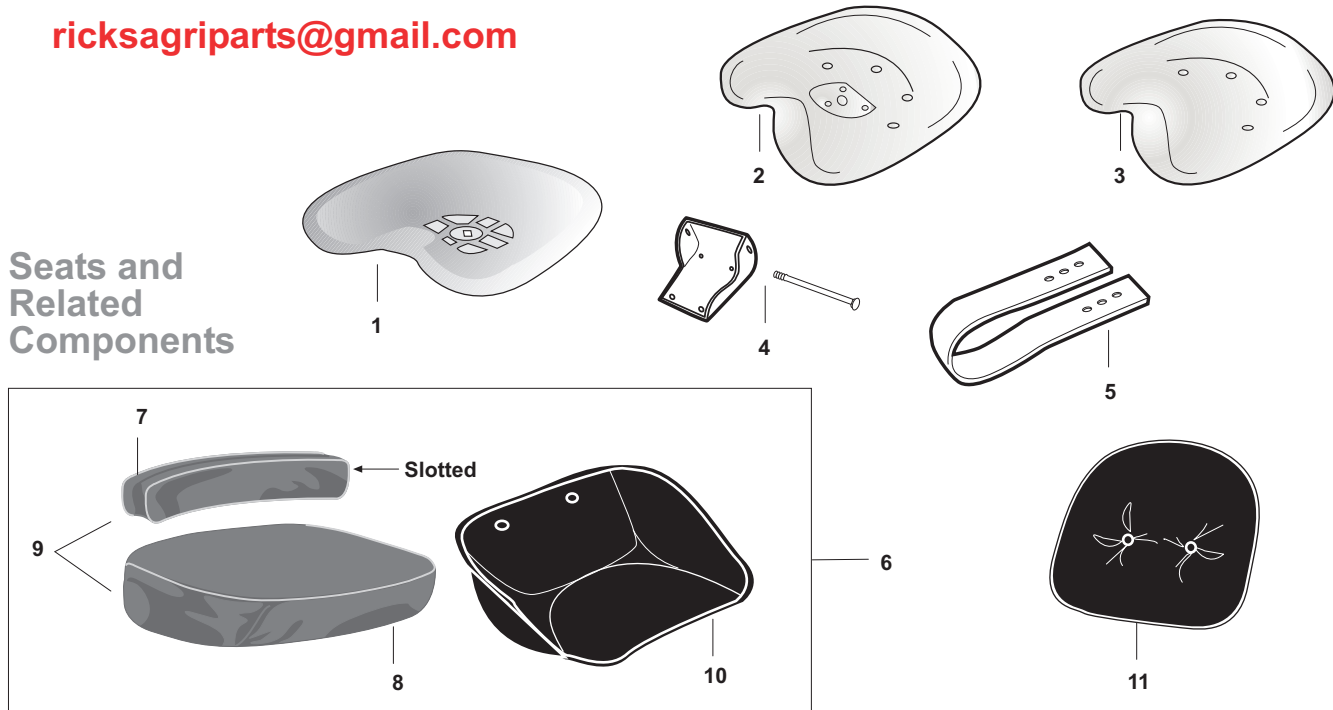

	OUR #	DESCRIPTION	EQUIVALENT	TRACTOR MODEL
1	R71478	Shallow Seat Pan (9/16" Square Hole)		Universal
2	R61598	Deep Dish Seat Pan (9/16" Square Hole)	825577M91	TE20, TEA20, TEF20
3	R61599	Flip-over Seat Pan	181330M91	TE20, TEA20, TO35, FE35, F40
4	R61557	Hinge & Bolt - Flip-over Seat	181322M1	TE20, TEA20, TO35, F40
5	R61516	Seat Spring (Use w/ R71478, R61598)	825608M1	TE20, TEA20, TEF20
6	R61390	Seat Pan w/ Cushion & Backrest - Grey Cushions Backrest Slotted for Adjustment		(TE20, TEA20, TEF20, TO20, TO30, TO35, FE35, F40 w/ Optional Deluxe Seat)
6	R43234	Seat Pan w/ Cushion & Backrest - Black Cushions Backrest Slotted for Adjustment		(TE20, TEA20, TEF20, TO20, TO30, TO35, FE35, F40 w/ Optional Deluxe Seat)
7	R00611	Backrest - Grey Backrest Slotted for Adjustment		(TE20, TEA20, TEF20, TO20, TO30, TO35, FE35, F40 w/ Optional Deluxe Seat)
8	R00612	Seat Cushion - Grey		(TE20, TEA20, TEF20, TO20, TO30, TO35, FE35, F40 w/ Optional Deluxe Seat)
9	R00610	Backrest & Cushion Assembly - Grey		(TE20, TEA20, TEF20, TO20, TO30, TO35, FE35, F40 w/ Optional Deluxe Seat)
9	R43096	Backrest & Cushion Assembly - Black		(TE20, TEA20, TEF20, TO20, TO30, TO35, FE35, F40 w/ Optional Deluxe Seat)
10	R61144	Metal Seat Pan - Black Primer	181313M93	Universal
11	R52666	Vinyl Seal Cushion - Black - Solid Foam (19")		Universal - Fits: R71478, R61598, R61599